

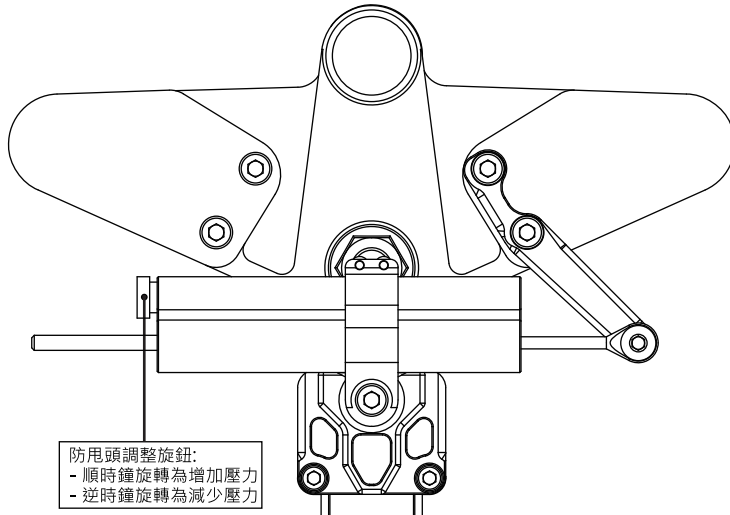

## ※注意事項※

- 本產禁用於氣動工具拆裝。
- 取用時請勿自行修改原物件或以外力施壓變形，以免造成結構破壞，影響安全。
- 安裝本產品時，請務必參照使用安裝說明書，避免安裝錯誤造成損壞，如有以上情形，本公司不予以保固。
- 本產品適用於WRRP雙管型防甩頭，如安裝其他種類防甩頭，請注意個細節有可能不符說明書規範，如造成損壞，一概由消費者自行負責。
- 如在安裝時發現與說明書不符或有疑慮，應盡快連絡本公司，洽尋各服務人員處理。
- 謝謝您的購買，祝您使用愉快。
- 如需其他產品，請至本公司網址 [www.wrrp.com.tw](http://www.wrrp.com.tw)



## 轉向防甩頭支架組

### ZXD 零件列表

①	ZXD-01	1
②	ZXD-02	1
③	ZXD-04	1
④	防甩頭夾具	1
⑤	M6 X 50 一般內六角螺絲	2
⑥	M8 X 70 一般內六角螺絲	1
⑦	M8 X 35 一般內六角螺絲	2
⑧	M8 X 25 一般內六角螺絲	1

### 第一步：

#### 移除油箱，側板與坐墊

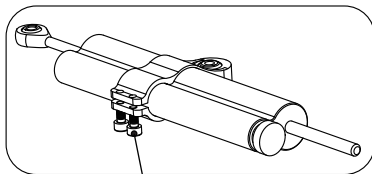

⑤a 防甩頭夾具



請上螺絲膠

#### ✳ 扭力矩

A: 5-9Nm / 44-80Lbs.In / 4.0-6.4Lbs.Ft  
 B: 14-17Nm / 124-150Lbs.In / 10.3-12.5Lbs.Ft  
 C: 6Nm / 53Lbs.In / 4.4Lbs.Ft

單位：

Nm=牛頓/米 Lbs.In=磅/英吋 Lbs.Ft=磅/英尺

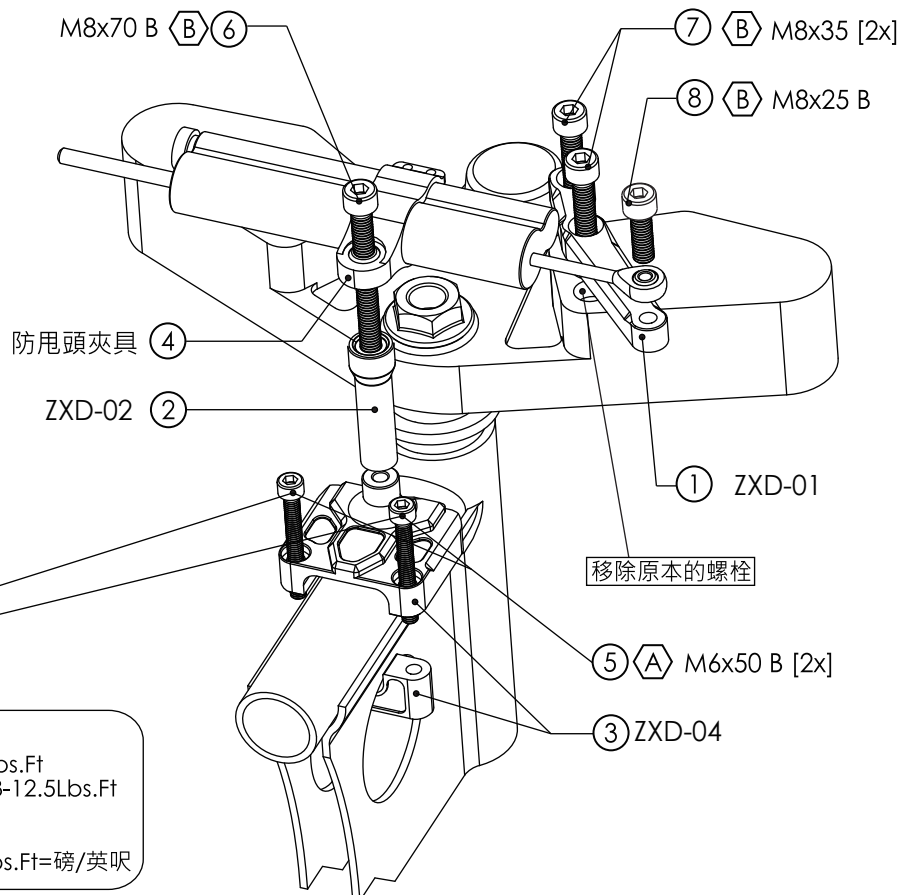



## ※ Attention ※

- Please do not use pneumatic tools on this product.
- Please do not modify or deform any parts in order to prevent structural damage and keep the safety.
- Please refer the installation manual before installation, all failures from non-standard installation does not due to WRRP.
- If any inconsistencies or uncertainties appear on the manual during installation, please contact our customer service as soon as possible.
- Thanks for your purchase, have a nice user experience.
- Further products on our website [www.wrrp.com.tw](http://www.wrrp.com.tw)

## STEERING DAMPER MOUNTING KIT

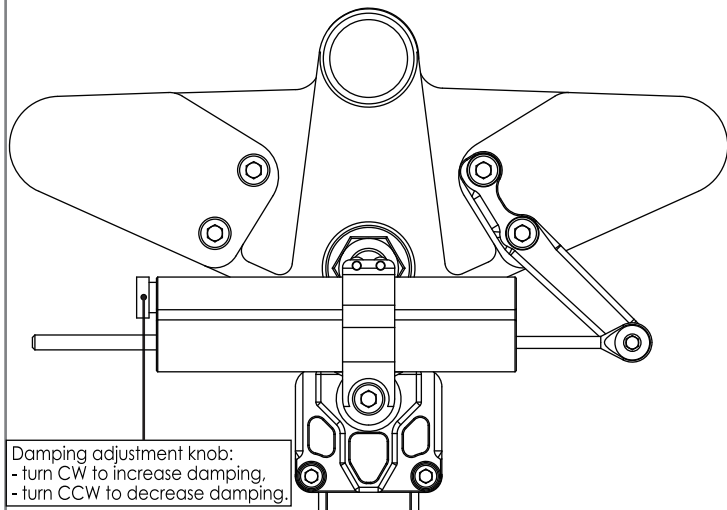

### ZXD PART LIST

①	ZXD-01	1
②	ZXD-02	1
③	ZXD-04	1
④	Clamp	1
⑤	M6 X 50 Socket head	2
⑥	M8 X 70 Socket head	1
⑦	M8 X 35 Socket Head	1
⑧	M8 X 25 Socket head	2

### Step 1: remove the tank, side panels and seat

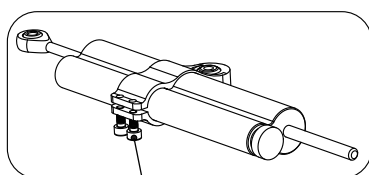

⑤c Clamp bolt

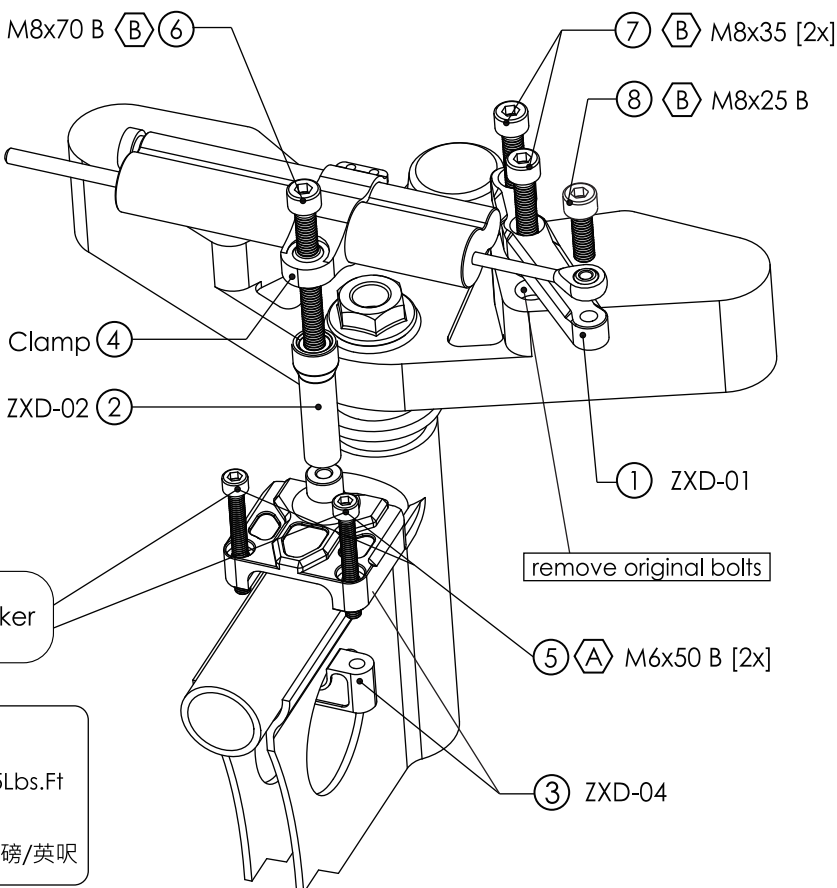

Please Applide Thread Locker

\* 扭力矩

A: 5-9Nm / 44-80Lbs.In / 4.0-6.4Lbs.Ft

B: 14-17Nm / 124-150Lbs.In / 10.3-12.5Lbs.Ft

C: 6Nm / 53Lbs.In / 4.4Lbs.Ft

單位:

Nm=牛頓/米 Lbs.In=磅/英吋 Lbs.Ft=磅/英尺